

Models 72913

Panel Mt IEC1010 4mm (0.16in) jack for sheathed banana

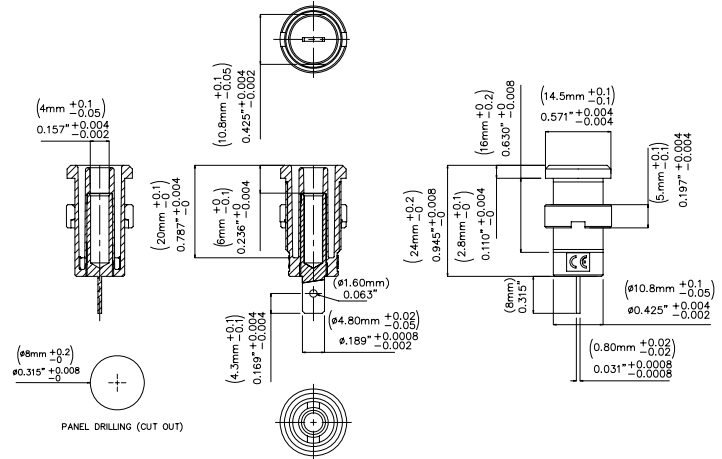
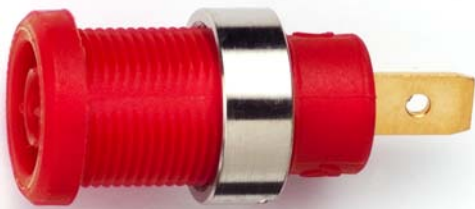

Features

- Panel Mt IEC1010 4mm (0.16in) jack for sheathed banana plugs.

Materials

- Body: Polyamide.
- Nut: Nickel plated
- Solder Tab: Gold plated Nickel brass.

Ordering Information

Model: 72913-Color sold in packages of 10 pieces.
Available colors: Black (-0), Red (-2)

Specifications

Max Current	36A
Max Voltage	1000 V CAT III
Max Resistance	Less than 5 m Ω

USA: Sales: 800-490-2361 Technical Support: 800-241-2060 Fax: 888-403-3360

Europe: 31-(0) 40 2675 150 International: 425-446-5500

e-mail: technicalsupport@pomonatest.com

Where to Buy: www.pomonaelectronics.com

All dimensions are in inches. Tolerances (except noted): .xx = ±.02" (.51 mm), .xxx = ±.005" (.127 mm). All specifications are to the latest revisions. Specifications are subject to change without notice. Registered trademarks are the property of their respective companies.